

## G03SHW Spoked Steel Control Handwheel

### Features

- Superstrong yet light-weight and extremely cost effective
- Special bore sizes available (MOQs apply)

### Material

- Body: Pressed steel, matt black
- Insert: Steel central hub with machined bore and keyway

### KEYWAY:

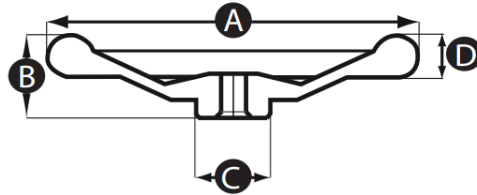
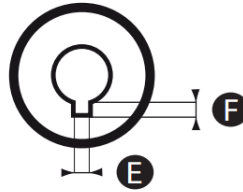

Part No.	A	B	C	D	E	F	Bore Diameter	No. of Spokes
G03SHW-11840V	125	29	30	18	4	2	11	3
G03SHW-11841R	160	37	30	22	4	2.3	12	4
G03SHW-11842Y	200	46	40	22	5	2.4	14	4
G03SHW-11843U	250	52	45	30	5	2.5	17	5

## G03SSHW Spoked Stainless Steel Control Handwheel

### Features

- Superstrong yet light-weight and extremely cost effective
- Special bore sizes available (MOQs apply)

### Material

- Body: Pressed stainless steel, natural matt
- Insert: Stainless steel central hub with machined bore and keyway

### KEYWAY:

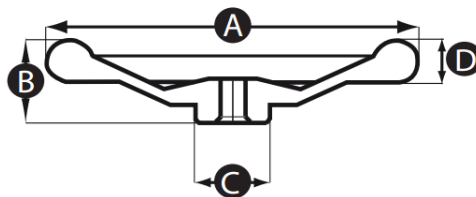
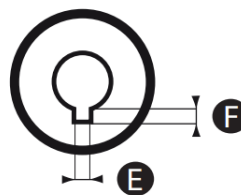

Part No.	A	B	C	D	E	F	Bore Diameter	No. of Spokes
G03SSHW-11837W	160	37	30	22	4	2.3	12	4
G03SSHW-11838S	200	46	40	22	5	2.4	14	4
G03SSHW-11839Z	250	52	45	30	5	2.5	17	5